

# Application Note 1012

## Drain Line Applications

## Table of Contents

Condensate drain pipe connection guidelines .....**Error! Bookmark not defined.**

## Condensate drain pipe connection guidelines

- Use PVC piping for the drain line.
- When connecting the PVC piping, use adhesive to attach the supplied drain socket.
- Ensure that the drain line (pipe) is properly routed through the wall hole and inclined downwards (away from the indoor unit) as shown in Figure 1.
- The end of the drain line (pipe) must be lower than the drain outlet of the indoor unit.
- Ensure that there are no peaks and valleys in the run of the drain line that may cause trapped drainage. Do NOT install traps in the drain line.
- Ensure that the discharge end of the drain line is NOT submerged in water in a drainage ditch or receptacle.
- Ensure that there is more than 2" (5cm) between the end of the drain line and any obstacles that may impede free flow of condensate.
- When pipework is completed, check to make sure that water flows from the end of the drain pipe freely and ensure that water is not leaking from the drain pipe connections.

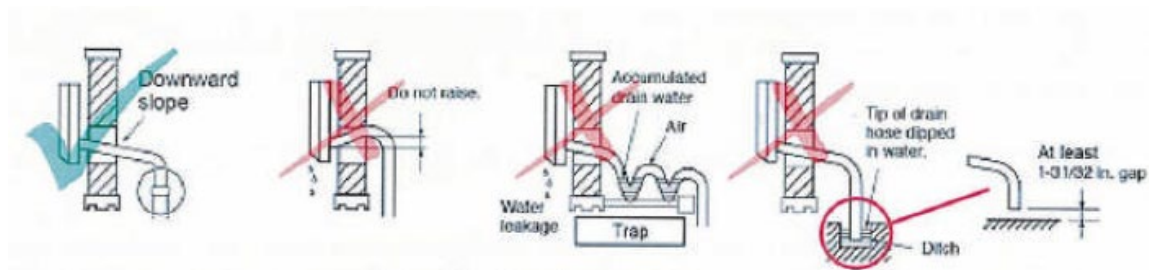

**Figure 1.** Condensate drain pipe connection