

FBM Series Filter Boxes

Designed for Mr SLIM® PEAD-A-AA Indoor Units

Job Name: _____

Drawing Reference _____

Schedule No. _____

GENERAL FEATURES

- All filter boxes include 2" thick pleated MERV 13 filter(s) installed
Rated MERV 13 when tested in accordance with ANSI/ASHRAE 52.2 Standard
Rated Class 2 under U.L. Standard 900
- Cabinet is constructed of 20 gauge G-60 galvanized steel
- Knurled thumb screws on access door allow easy filter replacement
- Foam gasket provides air-tight connection to indoor unit and access door
- Gasket material complies with UL 723 requirements
- Screw-through cabinet design for secure attachment to indoor unit
- Return connection in back easily field converted to bottom
- Filter access door includes area to record maintenance schedule

**Meets LEED
requirement
of MERV 13**

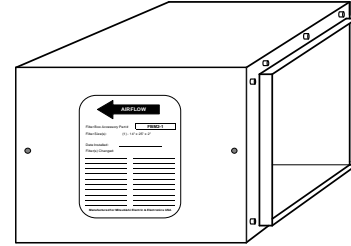

SPECIFICATIONS

Part Number	Used on CITY MULTI Models	Filters Included	Ship Weight lbs.	Net Weight lbs.
FBM2-3	PEAD-A24,30AA	(2) - 14" x 20" x 2"	35	32
FBM2-4	PEAD-A36,42AA	(2) - 14" x 20" x 2", (1) - 14" x 14" x 2"	44	41

EXTERNAL DIMENSIONS

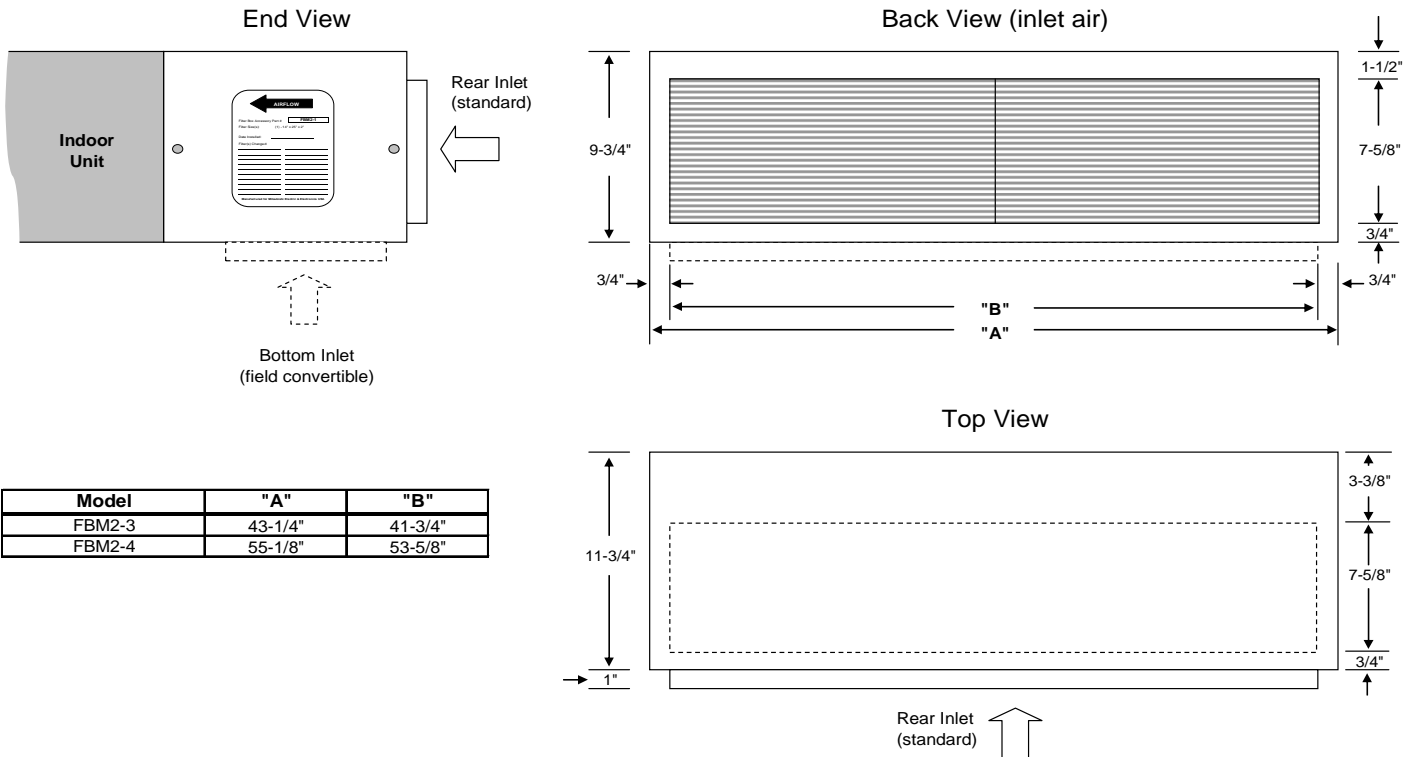

Model	"A"	"B"
FBM2-3	43-1/4"	41-3/4"
FBM2-4	55-1/8"	53-5/8"

Initial Filter Pressure Drop with 2" MERV 13 Filter(s) Installed

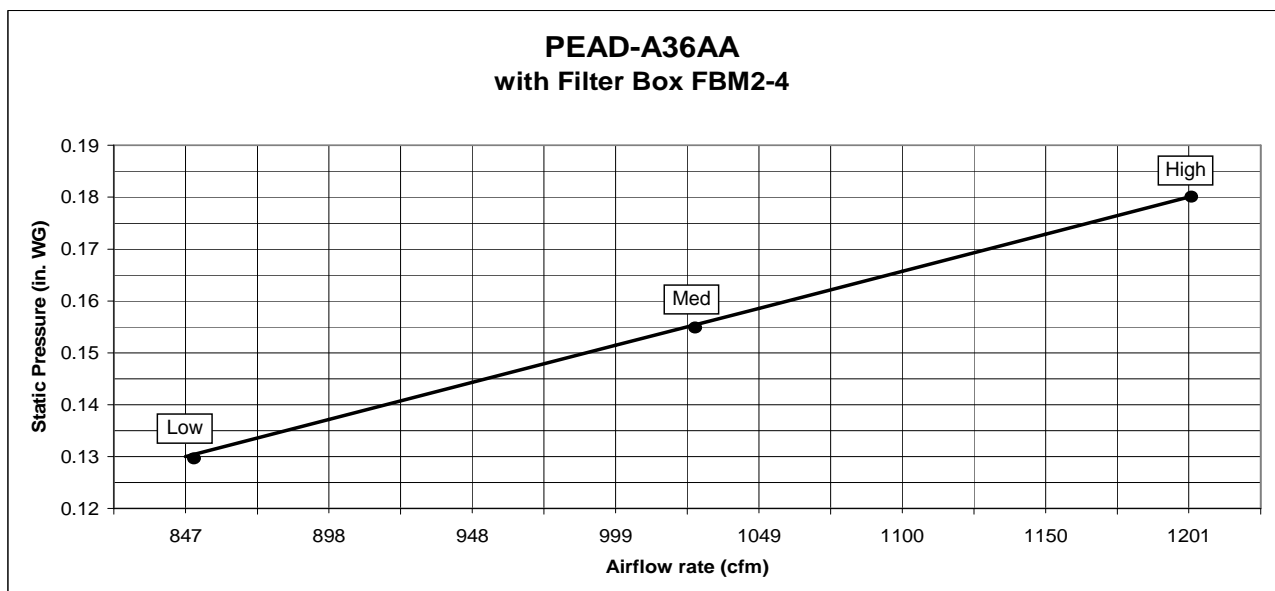
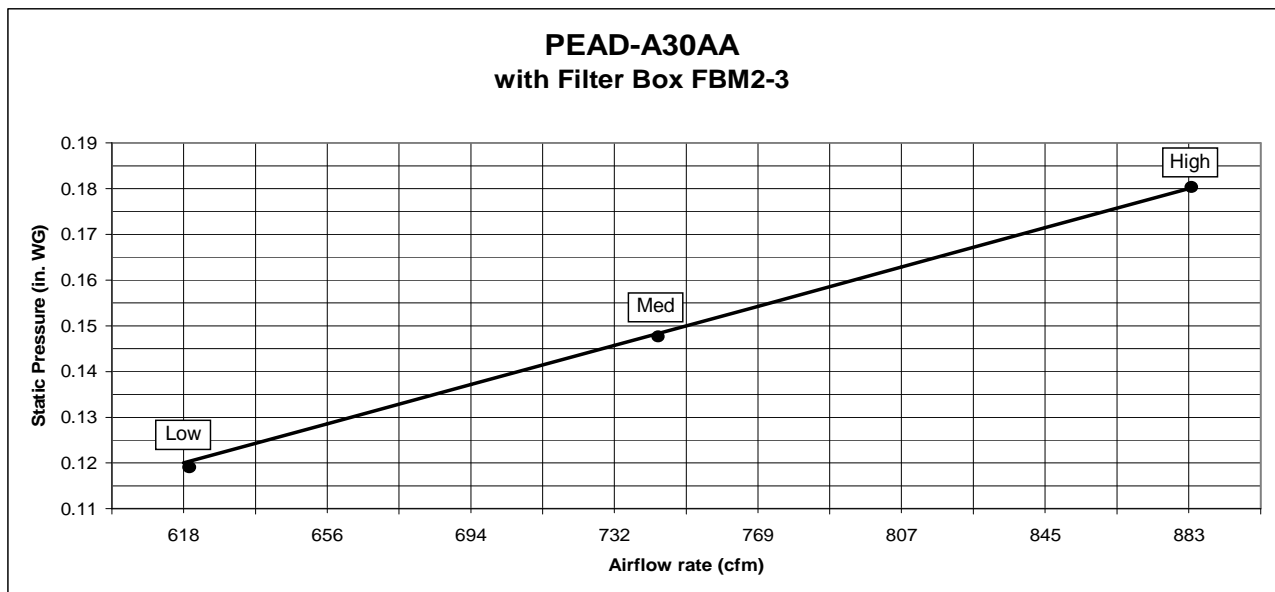
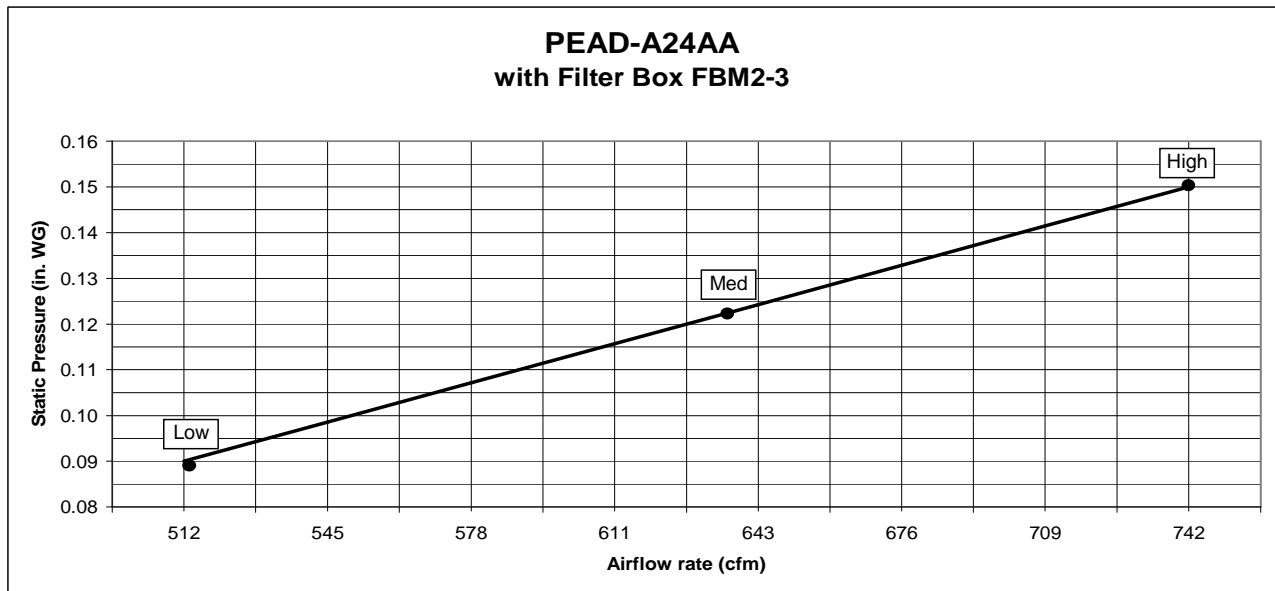

**PEAD-A42AA
with Filter Box PBM2-4**

